

**DESIGN SPECIFICATIONS:**

THE EXTERIOR APPEARANCE OF BUILDS IN THESE PLANS IS FOR DESIGN REFERENCE ONLY. ACTUAL COLORS AND FINISHES ARE SUBJECT TO VARIATION DUE TO NATURAL LIGHT AND MATERIAL FACTORS. THE MATERIAL, COLOR, AND HARDWARE HAVE BEEN SELECTED FOR THE BEST ENGINEERING SOLUTION WHILE REMAINING WITHIN THE APPROVED BUDGET.

**DIMENSION SPECIFICATIONS:**

DIMENSIONS ARE BASED ON CONSTRUCTION BLUE PRINTS. IT IS MANDATORY FOR THE CONTRACTOR/INSTALLER TO PERFORM A THOROUGH SECOND VERIFICATION OF ALL CRITICAL SITE DIMENSIONS PRIOR TO FABRICATION OR COMMENCING WORK. THE DESIGNER IS NOT RESPONSIBLE FOR ERRORS RESULTING FROM UNVERIFIED DIMENSIONS.

**ACCESS TO PRODUCT SPECS AND 3D VISUALIZATION:**

THIS SET OF DRAWINGS CONTAINS HYPERLINKS HIGHLIGHTED IN YELLOW. CLICKING ON A HIGHLIGHTED NOTE WILL DIRECT YOU TO THE PRODUCT SPECIFICATION WEBPAGE. ADDITIONALLY, THE "3D MODEL LINK" HYPERLINK WILL OPEN A WEBPAGE CONTAINING BOTH A 3D RENDERED VIDEO PRESENTATION AND AN INTERACTIVE, NAVIGABLE 3D MODEL.

[3D MODEL LINK](#)

**POWDER ROOM**

- SCOPE OF WORK IS PENDING APPROVAL OF DESIGN CONCEPTS

NOT INCLUDED IN PRICING AND/OR PROVIDED BY OTHERS OR VIA AN APPROVED TIME AND MATERIAL AGREEMENT

- PENDING

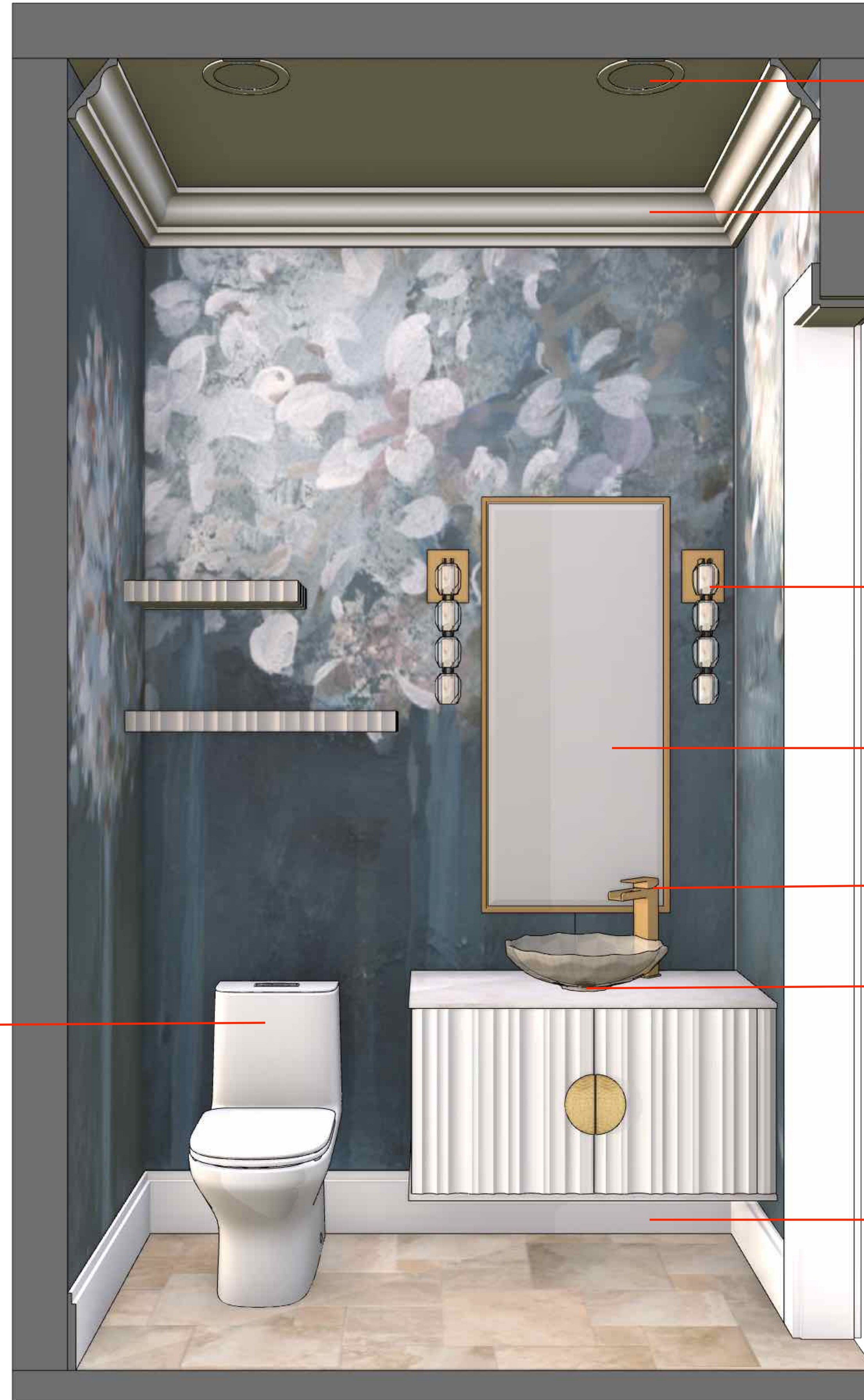

RE-ARRANGE CEILING LIGHTS

KEEP EXISTING CROWN

SEDUCTION - SFV2568310

[PRODUCT LINK](#)

CUSTOM MADE BEVELED EDGE MIRROR W/ CHEMETAL FRAME

KIBI WATERFALL BRASS SINGLE HAND FAUCET - CKBFB1005-KPW101

[PRODUCT LINK](#)

VESSEL SINK BRIOLETTE K-2372-TG7

[PRODUCT LINK](#)

KEEP EXISTING BASEBOARD

REPLACE THE TOILET?

[OPT#1 PRODUCT LINK](#)

[OPT#2 PRODUCT LINK](#)



**CABINET INTERIOR:**  
3/4 NATURAL MAPLE PLYWOOD

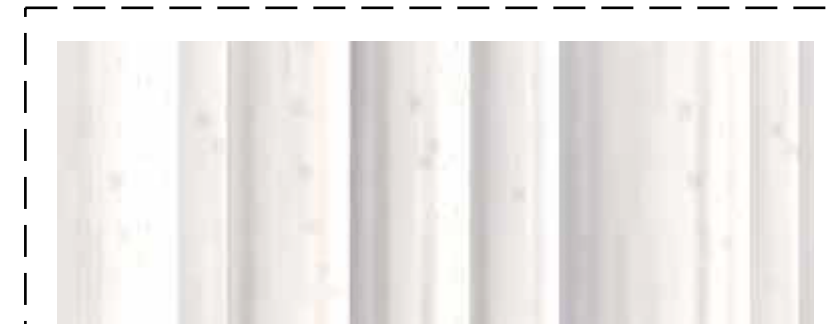

**CABINETS EXTERIOR:**  
METALLIC WHITE  
**DOOR PROFILE:**  
3D WAVY CARVED FRONTS

[EXAMPLE LINK](#)



**COUNTERTOP:**  
PENDING SELECTION

[SLAB LINK](#)

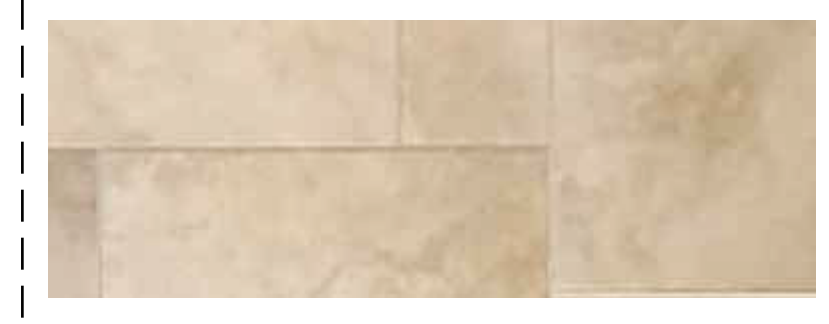

**FLOORING:**  
REMAINS AS IS



**WALLPAPER:**  
AGAPANTHUS - WALLISM

[WALLPAPER LINK](#)

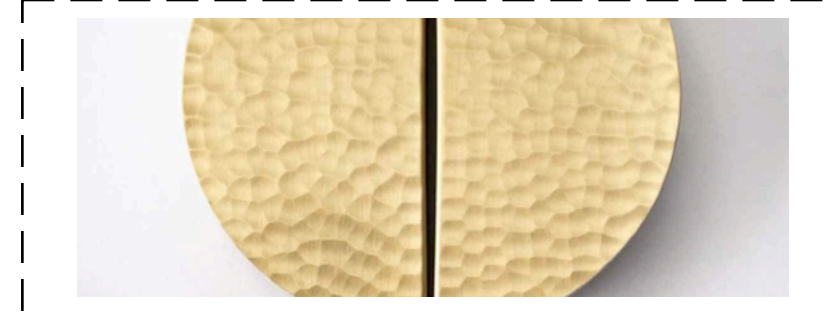

**CABINET DECORATIVE HANDLE:**  
HAMMERED DEMI LUNE (6")

[SPECS LINK\\*](#)

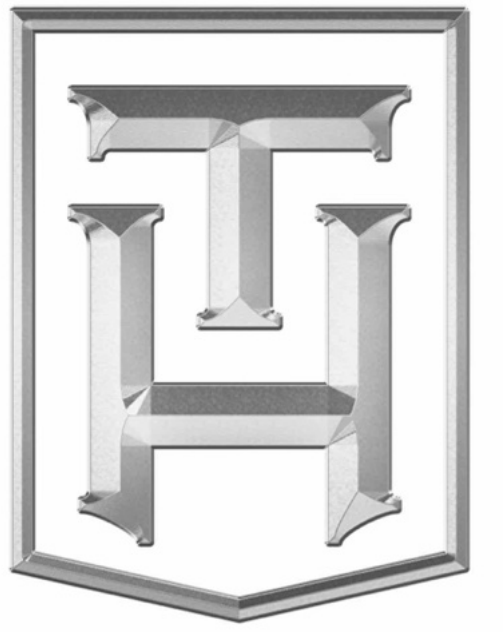

**TRULY HANDY**

28280 Old 41 Rd, Unit M7  
Bonita Springs, FL, 34135  
Tel: 239-221-9151

**QUILTY RESIDENCE**

**CLIENT**  
Patricia Quilty  
8610 Cavano St  
Naples, FL, 34119

**DESIGNER**  
Eduardo Beluco  
eduardo@trulyhandyllc.com

**PROJECT**  
**POWDER ROOM**

**NOTES:**

**DATE: 02/26/26**

**APPROVAL SIGNATURE:**

**APPROVAL STATUS:**  
**PENDING**

**SCHEDULING DISCLAIMER:**  
All preliminary schedules are created based on approved drawings. Schedules will be automatically adjusted to reflect the final approval date. We will notify everyone of the updated timeline as soon as available. Any delays in the approval of drawings and finishes will potentially delay the project delivery / install date.

Truly Handy LLC makes no representation or warranties, express or implied, with respect to the reuse of the data provided herewith, regardless of its format or the means of its transmission. There is no guarantee or representation to the user as to the accuracy, currency, suitability or reliability of this data for any purpose. The user accepts the data "as is", and assumes all risks associated with its use. By acceptance of this data, the user agrees not to transmit this data or provide access or any part of it to another party unless the user shall include with the data a copy of this disclaimer. Truly Handy LLC assumes no responsibility for actual or consequential damage incurred as a result of any user's reliance on this data. Final engineering subject to change without notice.

**PAGE:**

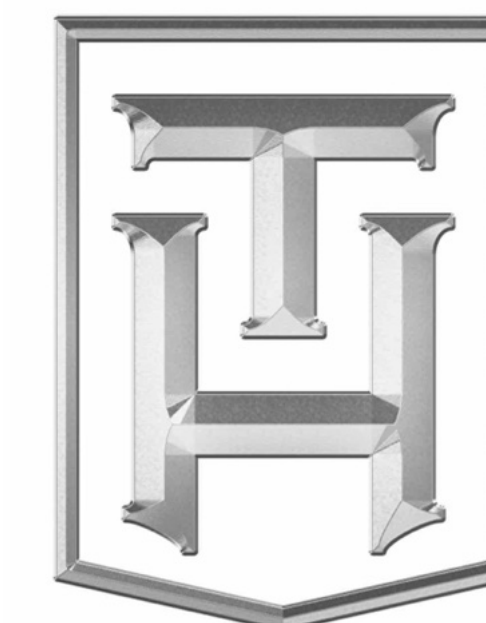

**TRULY  
HANDY**

28280 Old 41 Rd, Unit M7  
Bonita Springs, FL, 34135  
Tel: 239-221-9151

**QUILTY  
RESIDENCE**

**CLIENT**  
Patricia Quilty  
8610 Cavano St  
Naples, FL, 34119

**DESIGNER**  
Eduardo Beluco  
eduardo@trulyhandyllc.com

**PROJECT**  
**POWDER ROOM**

**NOTES:**

**DATE: 02/26/26**

**APPROVAL SIGNATURE:**

**APPROVAL STATUS:**  
**PENDING**

**SCHEDULING DISCLAIMER:**  
All preliminary schedules are created based on approved drawings. Schedules will be automatically adjusted to reflect the final approval date. We will notify everyone of the updated timeline as soon as available. Any delays in the approval of drawings and finishes will potentially delay the project delivery / install date.

Truly Handy LLC makes no representation or warranties, express or implied, with respect to the reuse of the data provided herewith, regardless of its format or the means of its transmission. There is no guarantee or representation to the user as to the accuracy, currency, suitability or reliability of this data for any purpose. The user accepts the data "as is", and assumes all risks associated with its use. By acceptance of this data, the user agrees not to transmit this data or provide access or any part of it to another party unless the user shall include with the data a copy of this disclaimer. Truly Handy LLC assumes no responsibility for actual or consequential damage incurred as a result of any user's reliance on this data. Final engineering subject to change without notice.

**PAGE:**



**1** **FLOATING SHELVES**  
**SH** Scale: 1-1/2" = 1'-0"



**PV** **PLAN VIEW - POWDER ROOM**  
**1** Scale: 1-1/2" = 0.5' 1'-0"

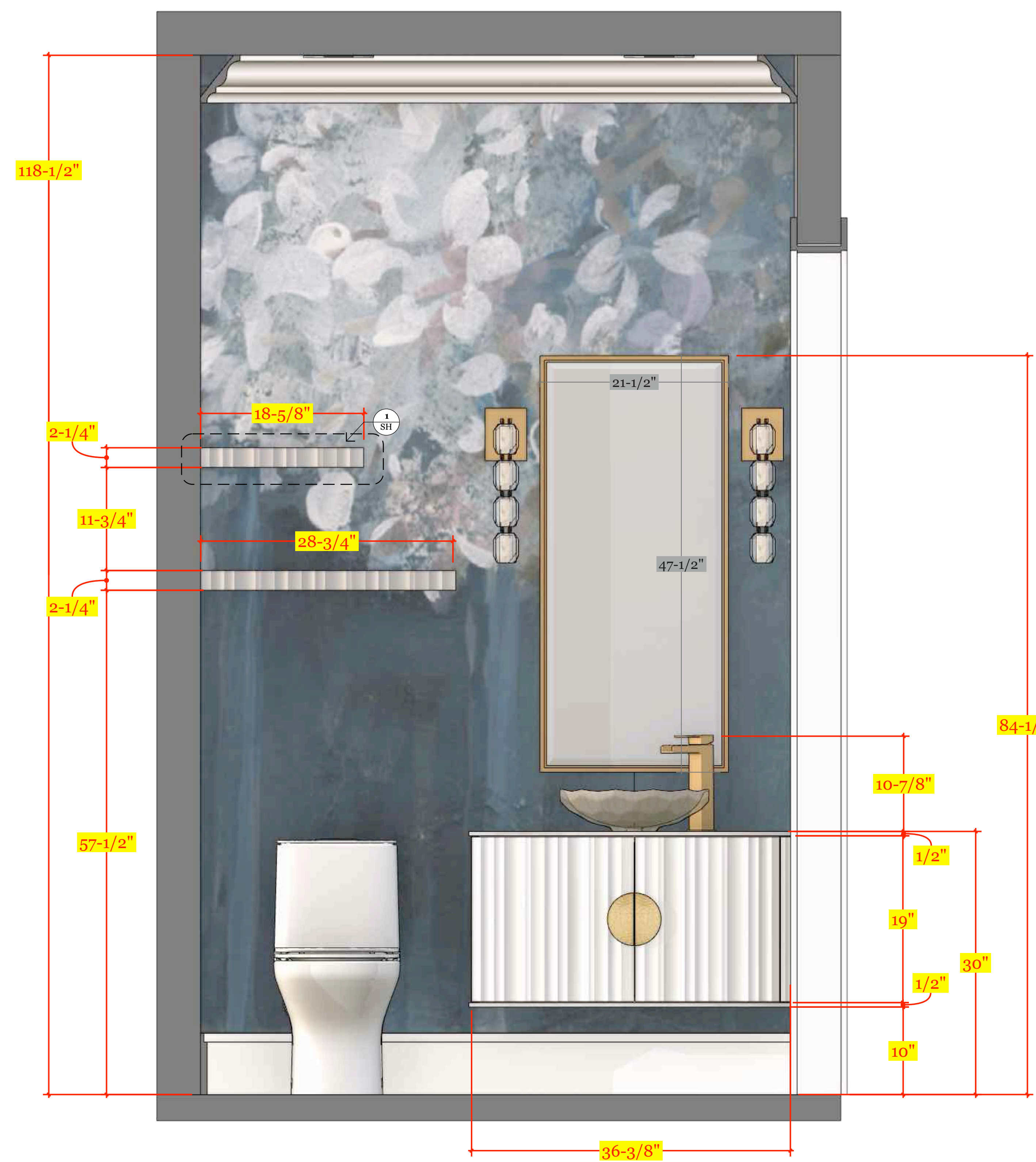

**ELV** **ELEVATION A**  
**A** Scale: 1-1/2" = 1'-0"

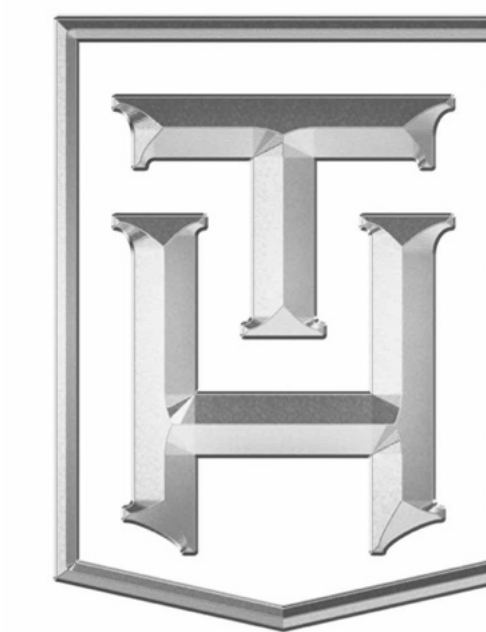

**TRULY  
HANDY**

28280 Old 41 Rd, Unit M7  
Bonita Springs, FL, 34135  
Tel: 239-221-9151

**QUILTY  
RESIDENCE**

**CLIENT**  
Patricia Quilty  
8610 Cavano St  
Naples, FL, 34119

**DESIGNER**  
Eduardo Beluco  
eduardo@trulyhandyllc.com

**PROJECT**  
**POWDER ROOM**

**NOTES:**

**DATE: 02/26/26**

**APPROVAL SIGNATURE:**

**APPROVAL STATUS:**  
**PENDING**

**SCHEDULING DISCLAIMER:**  
All preliminary schedules are created based on approved drawings. Schedules will be automatically adjusted to reflect the final approval date. We will notify everyone of the updated timeline as soon as available. Any delays in the approval of drawings and finishes will potentially delay the project delivery / install date.

Truly Handy LLC makes no representation or warranties, express or implied, with respect to the reuse of the data provided herewith, regardless of its format or the means of its transmission. There is no guarantee or representation to the user as to the accuracy, currency, suitability or reliability of this data for any purpose. The user accepts the data "as is", and assumes all risks associated with its use. By acceptance of this data, the user agrees not to transmit this data or provide access or any part of it to another party unless the user shall include with the data a copy of this disclaimer. Truly Handy LLC assumes no responsibility for actual or consequential damage incurred as a result of any user's reliance on this data. Final engineering subject to change without notice.

**PAGE:**

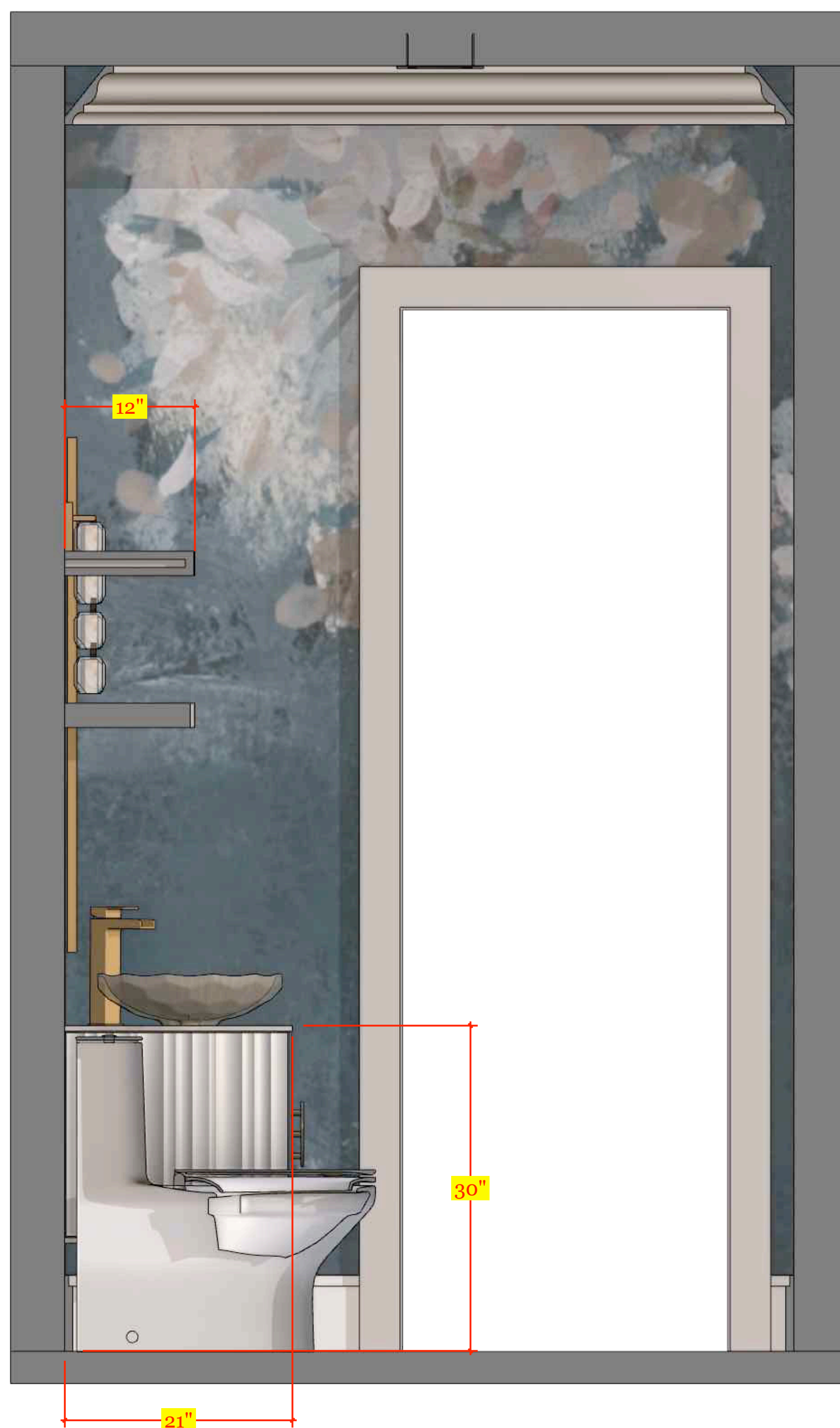

**ELV** ELEVATION B (SIDE VIEW)  
**B** Scale: 1-1/2" = 1'-0"

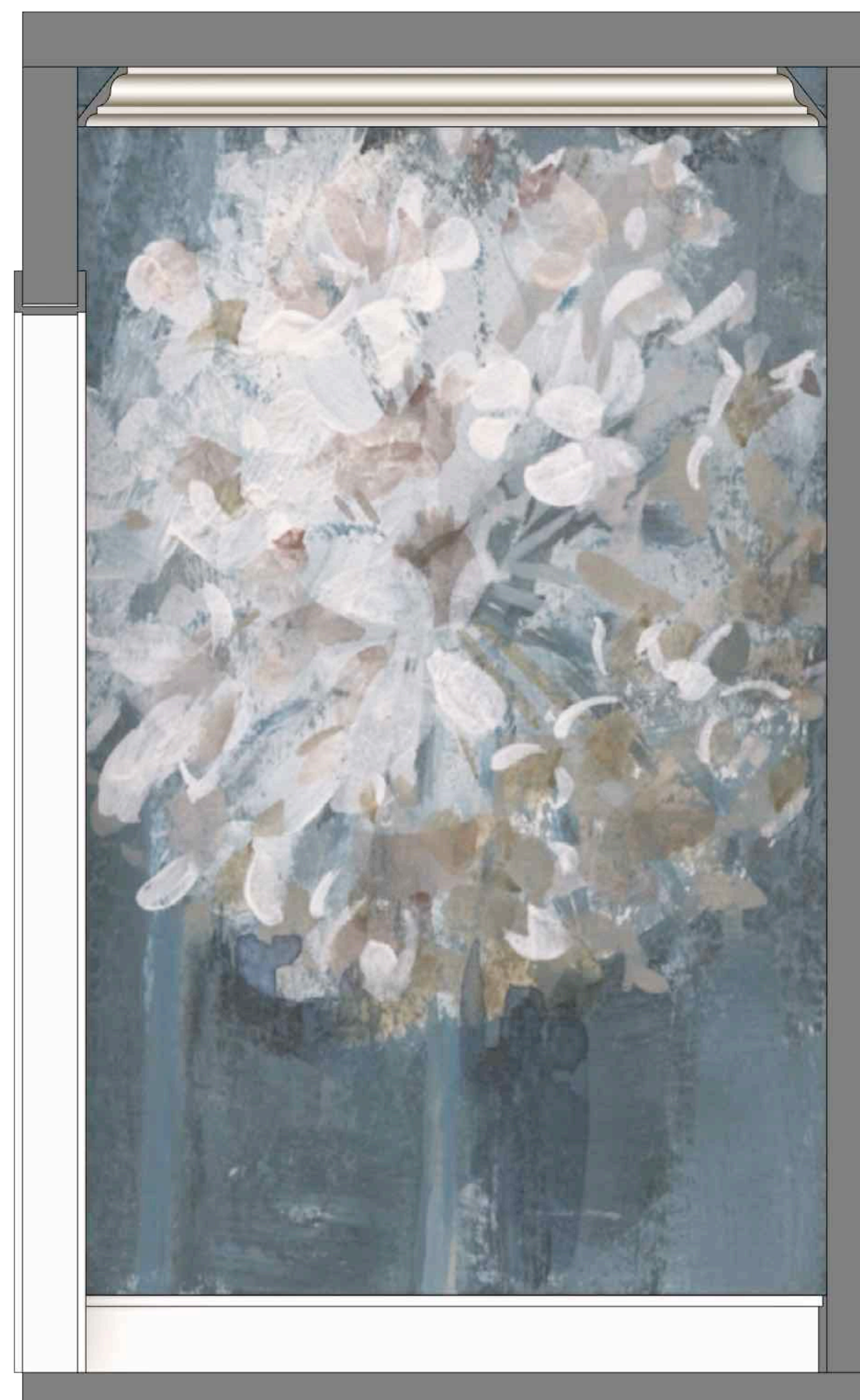

**ELV** ELEVATION C - CUSTOM ART PANEL PAINTED TO MATCH VANITY  
**C** Scale: 1-1/2" = 1'-0"

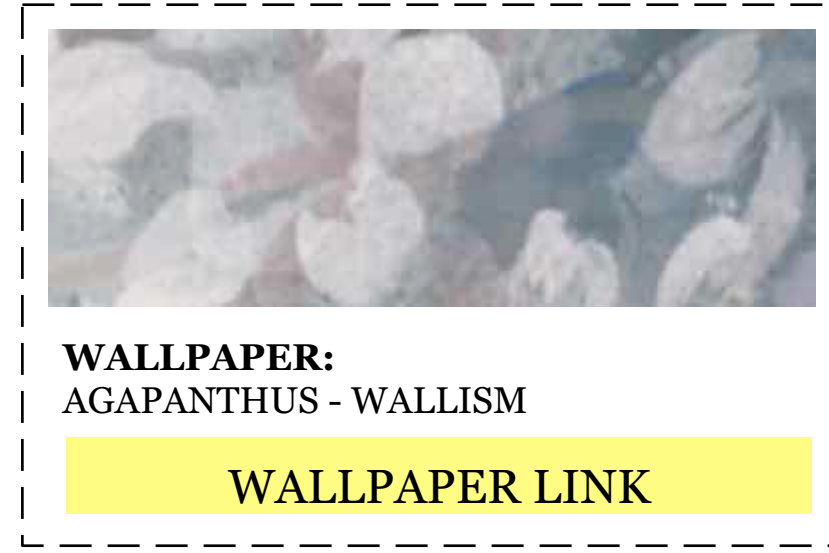

**WALLPAPER:**  
AGAPANTHUS - WALLISM

[WALLPAPER LINK](#)

**ELEV B**      **ELEV C**      **ELEV D**      **ELEV A**

**DOOR**

8'6"

22'8"

Mirror    ↗ Edit wallpaper size    ✂ Hide lengths    📌 Save for later

Show comparison    Hide options ▾

Premium

Premium Textured (+ \$154.14) Popular

Peel & Stick (+ \$539.48)

22'8" x 8'6" = 192.67 sq. ft      **Total: \$789.95**

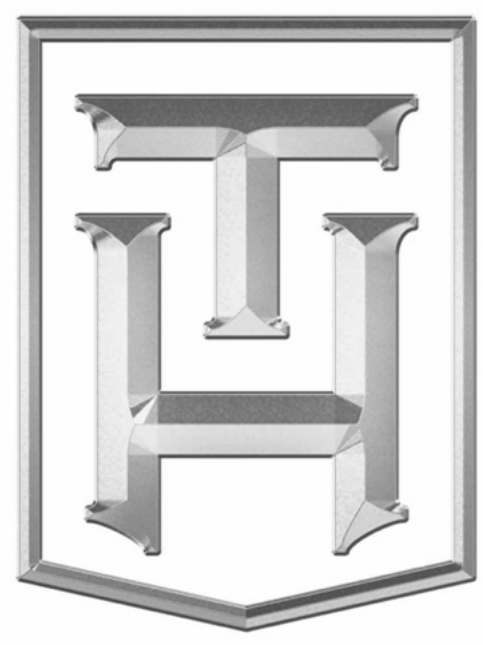

**TRULY  
HANDY**

28280 Old 41 Rd, Unit M7  
Bonita Springs, FL, 34135  
Tel: 239-221-9151

**QUILTY  
RESIDENCE**

**CLIENT**  
Patricia Quilty  
8610 Cavano St  
Naples, FL, 34119

**DESIGNER**  
Eduardo Beluco  
eduardo@trulyhandyllc.com

**PROJECT**  
**POWDER ROOM**

**NOTES:**

**DATE: 02/26/26**

**APPROVAL SIGNATURE:**

**APPROVAL STATUS:**  
**PENDING**

SCHEDULING DISCLAIMER:  
All preliminary schedules are created based on approved drawings. Schedules will be automatically adjusted to reflect the final approval date.  
We will notify everyone of the updated timeline as soon as available. Any delays in the approval of drawings and finishes will potentially delay the project delivery / install date.

Truly Handy LLC makes no representation or warranties, express or implied, with respect to the reuse of the data provided herewith, regardless of its format or the means of its transmission. There is no guarantee or representation to the user as to the accuracy, currency, suitability or reliability of this data for any purpose. The user accepts the data "as is", and assumes all risks associated with its use. By acceptance of this data, the user agrees not to transmit this data or provide access or any part of it to another party unless the user shall include with the data a copy of this disclaimer. Truly Handy LLC assumes no responsibility for actual or consequential damage incurred as a result of any user's reliance on this data. Final engineering subject to change without notice.

**PAGE:**



**WALLPAPER CUSTOM ORDER**

Name: Agapanthus - Design by Danhui Nai - Type Mural - Wallism ID (MPN) NKLPGoLoDoKm